

HEATSEEKER

HEATING ON A GRAND SCALE





Create the warmth and atmosphere of an open fire with the convenience and cleanliness of gas. The Heatseeker delivers optimum radiant and fan assisted convected heat. Offering total design flexibility ranging from old world to traditional or contemporary finishes. The Heatseeker fire is available in three convenient sizes that are ideal for new or existing fireplace applications.



HEATSEEKER

600 | 850 | 1000

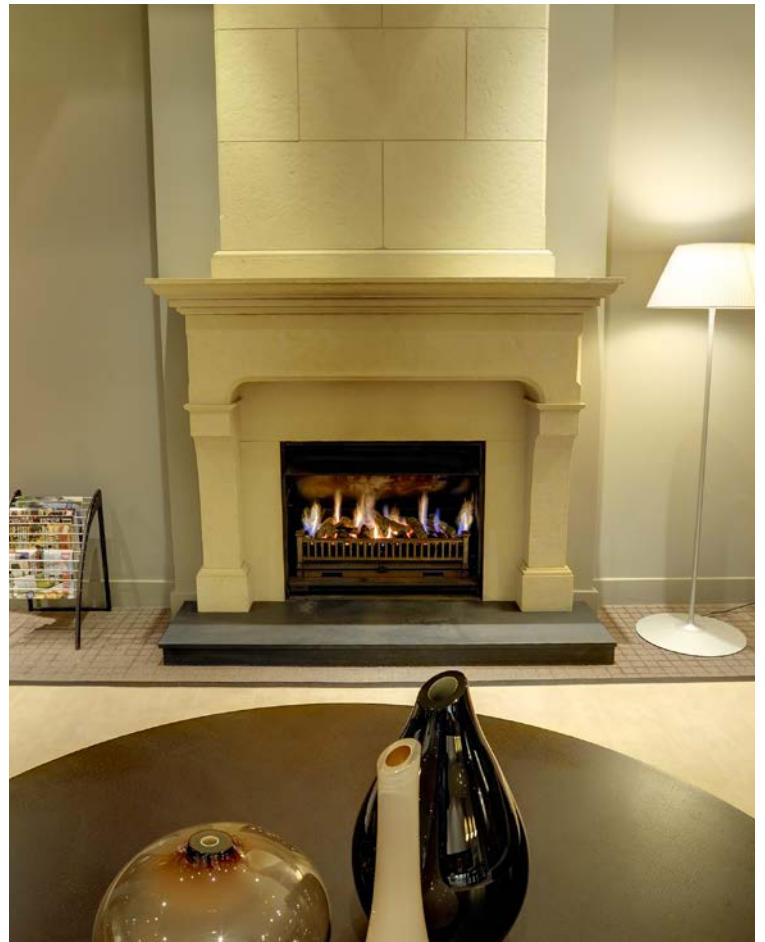
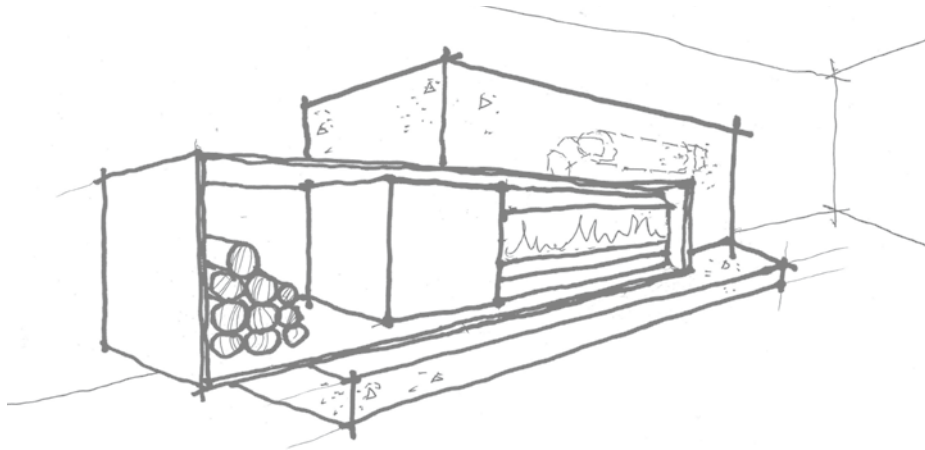

- 🔥 Natural gas or ULPG
- 🔥 Conventional or Power flue
- 🔥 Pebbles or Coals and Logs
- 🔥 New or existing applications
- 🔥 Old world, traditional or contemporary
- 🔥 Convected plus radiant heat, heats up to 45m²
- 🔥 600 Electronic Ignition
- 🔥 850 Electronic Ignition
- 🔥 1000 Electronic Ignition
- 🔥 Conceived, designed, researched, developed and built in Australia

TECHNICAL SPECIFICATIONS

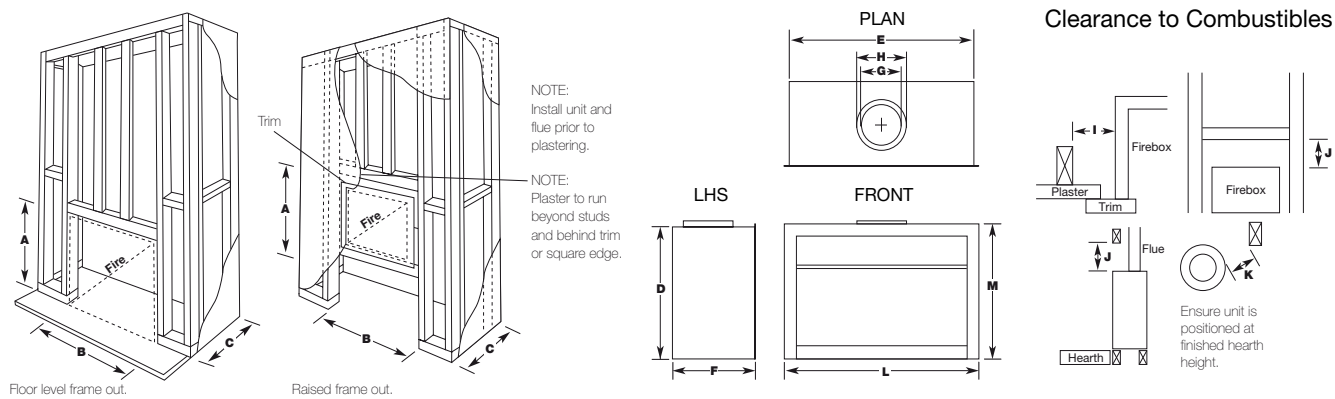

	A	B	C	D	E	F	G	H	I	J	K	L	M	NG Mj/h	LP Mj/h	GPO REQ'D	VENTILATION
600	750	750	450	650	675	415	150	200	25	100	25	740	670	37	31	YES	18000mm ²
850	750	1000	450	650	930	415	200	250	25	100	25	990	670	39	36	YES	32000mm ²
1000	750	1150	450	650	1075	415	200	250	25	100	25	1140	670	39	36	YES	32000mm ²

Also available in inbuilt configuration for working masonry fireplaces. Refer to TRIMS section for 4 sided trim dimension.
The firebox measurements are D,E,F.

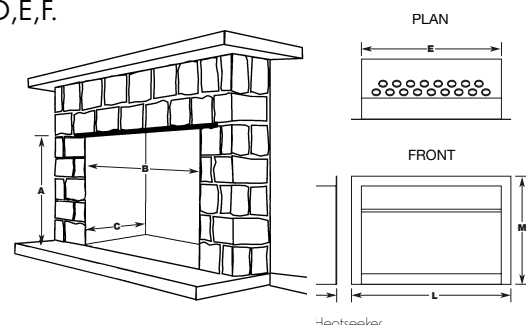

	A	B	C	D	E	F	L	M	NG Mj/h	LP Mj/h	GPO REQ'D	VENTILATION
HEATSEEKER 600	610	620	380	605	610	370	740	670	37	31	YES	4000mm ²
HEATSEEKER 850	610	870	380	605	860	370	990	670	39	36	YES	4000mm ²
HEATSEEKER 1000	610	1020	380	605	1005	370	1140	670	39	36	YES	4000mm ²

Refer to TRIMS section for 4 sided trim dimension.

Warranty: 15 years on the Firebox and 2 years on components.



Glen Dimplex New Zealand Ltd
P.O. Box 58473, Botany
Manukau 2163, New Zealand
Phone: 09 274 8265 Fax: 09 274 8472
Email: info@realflame.co.nz
www.realflame.co.nz

Glen Dimplex New Zealand Ltd's policy is one of continuous development. We reserve the right to change size and specifications without notice. For confirmation of Real Flame product details please refer to www.realflame.co.nz. Please refer to the installation and operation instructions before having your Real Flame Gas Fire installed. A full set of these instructions is supplied with each fire.